

Installation Instructions

.....

8597215 Trailer Hitch Mounted Tow Guard with 15" Rubber Flap

8597220 Trailer Hitch Mounted Tow Guard with 20" Rubber Flap



This symbol points out important safety instructions which, if not followed, could endanger the personal safety and/or property of yourself and others. Read and follow all instructions in this manual before attempting to install or operate this product. Failure to comply with these instructions may result in personal injury. When you see this symbol. **HEED ITS WARNING!**

WARNING

Improper installation and operation could cause personal injury, and/or property damage. Observe the following Safety Precautions before, during and after operating this tow guard. By following these precautions and common sense, possible injury to persons and potential damage to this accessory may be avoided.

IMPORTANT

For vehicles with rear exit exhausts that come in close contact with the mud flaps, we recommend cutting holes in the mud flaps or redirecting the exhaust tips to prevent heat damage.

- Read and fully understand the entire Installation and Operator's Manual before using the Tow Guard.
- Read and understand all instructions and safety precautions as outlined in all manufacturers' manuals for the trailer you are using
- Examine the spare tire carrier monthly for structural cracks, bends, damage and any other condition that may affect the safe operation of the product. Do not use if damaged in any way.
- It is the operator's responsibility to make sure the usage of this product meets all local motor vehicle laws and regulations. Do not obscure markers, tail-lights, running lights or license plate.
- Make certain the Tow Guard does not interfere with the trailer's normal movement or blocks the driver's view.

Fig. 1

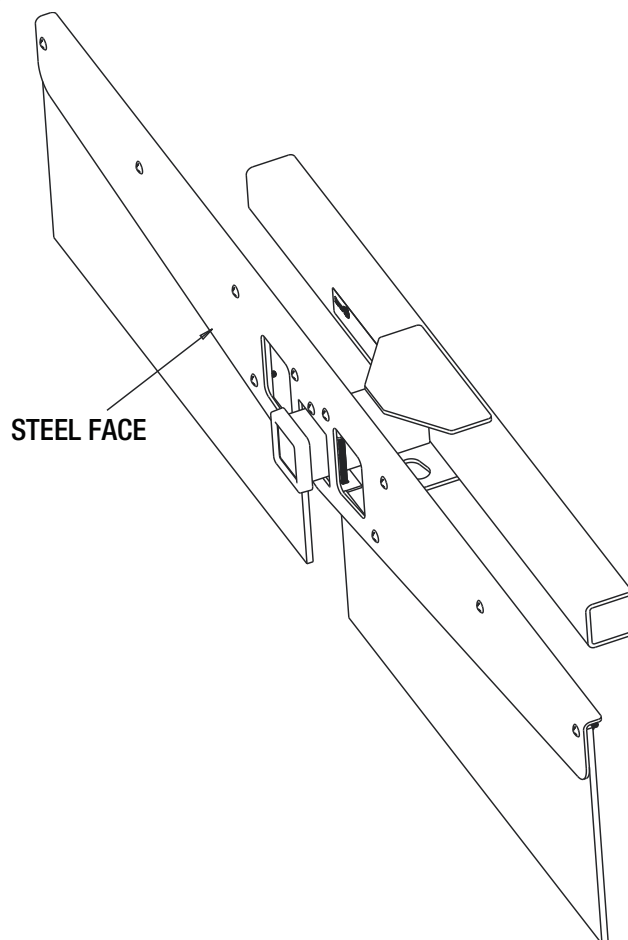

ASSEMBLY

- 1.** Place the tow guard over the 2-3" receiver hitch such that the steel face of the tow guard faces away from the bumper (see Figure 1).
- 2.** Making sure the tow guard is not touching the vehicle bumper; clamp the tow guard to the hitch by firmly tightening the carriage bolts (6) and hex nuts (10) so that the top (3) and bottom (4) mounts are tight enough to not move along the face of the square tube (see Figure 2).

Fig. 2

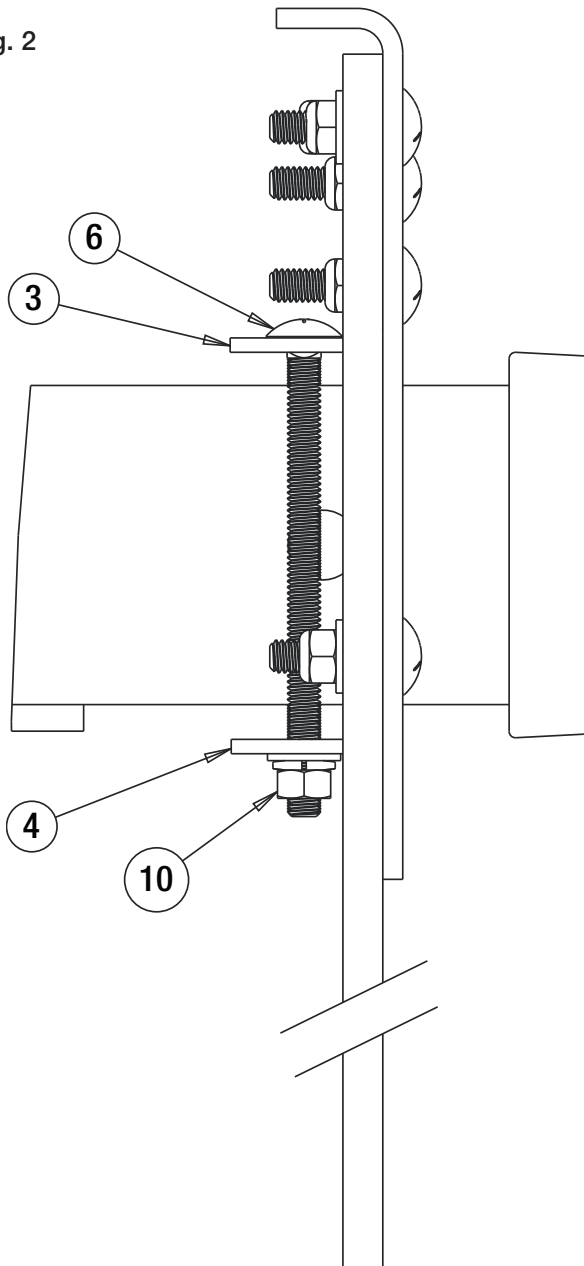

3. Make sure there is a clearance of 4-7" between the bottom of the mud flaps and the ground. The mud flaps can be trimmed to the desired length if necessary.

MAINTENANCE

- Examine the general condition of the tow guard for any damage or worn parts before installation and monthly after mounted to your hitch. Check all nuts and bolts to make sure they are secure and tight monthly. Have necessary repairs made by qualified service personnel.

Bill of Materials

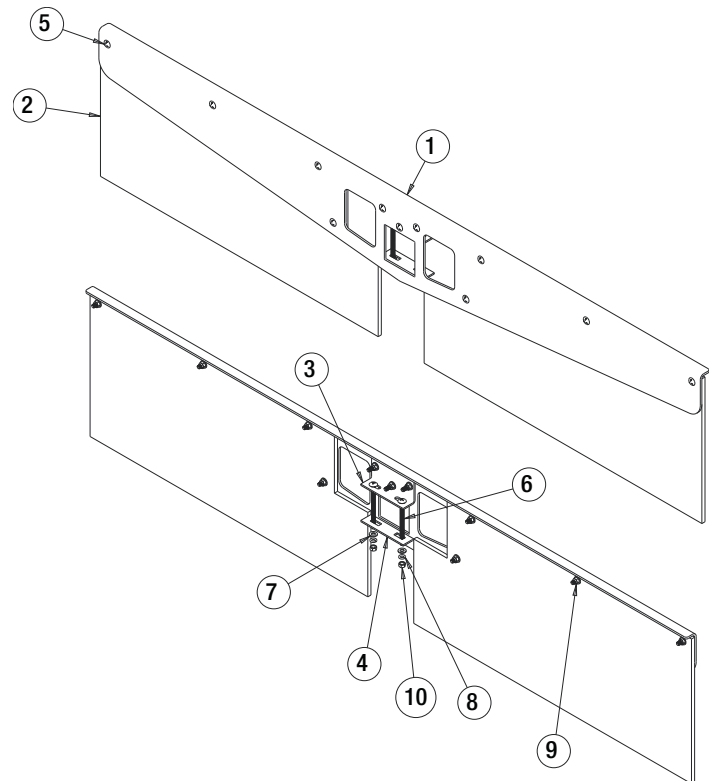

Bill of Materials

ITEM	PART NO.	QTY.	DESCRIPTION
1	3056826	1	MOUNT, TOW GUARD
2	3056827	2	MUD FLAP, 15 IN, TOW GUARD (8597215)
	3056828	2	MUD FLAP, 20 IN, TOW GUARD (8597220)
3	3056830	1	MOUNT, TOP, TOW GUARD
4	3056829	1	MOUNT, BOTTOM, TOW GUARD
5	3058479	11	BOLT, CARRIAGE, 5/16-18X1.25LG, GR5, ZN
6	3058274	2	BOLT, CARRIAGE, 5/16-18X4.50LG, GR5, ZN
7	FWF031075006SS	13	WASHER, FLAT, 5/16 X .688 X .065, SST
8	FWL031058008SS	2	WASHER, 5/16 LOCK SST
9	FNE031018034SS	11	NUT, NYLOCK, 5/16-18, SST WAX
10	FNH031018025SS	2	NUT, 5/16-18 HEX SST

WARRANTY

Buyers Products Co. warrants all truck/trailer hardware manufactured or distributed by it, to be free from defects in material and workmanship for a period of one year from date of shipment. Parts must be properly installed and used under normal conditions. Any product which has been altered, including modification, misuse, accident or lack of maintenance will not be considered under warranty. Normal wear is excluded. The sole responsibility of Buyers Products Co. under this warranty is limited to repairing or replacing any part or parts which are returned, prepaid, and are found to be defective by Buyers Products Co. Authorization from Buyers Products Co. must be obtained before returning any part. No charges for transportation or labor performed on Buyers' products will be allowed under this warranty.